

## Wire Harness Side

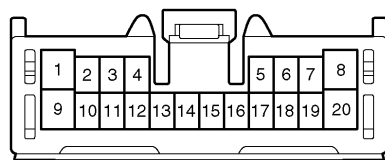

N

I11468

**INSPECTION**

- Connector disconnected:  
INSPECT POWER WINDOW MASTER SWITCH CIRCUIT**

Disconnect the connectors from the switch and inspect connector on the wire harness side.

Tester connection	Condition	Specified condition
9 - Ground	Always	Continuity
1, 5 - Ground	Always	Battery Positive Voltage
2, 4 - Ground	Ignition switch LOCK	No voltage
2, 4 - Ground	Ignition switch ACC or ON	Battery Positive Voltage
15 - Ground (LHD)	Driver's door key lock and unlock switch LOCK	No Continuity
15 - Ground (LHD)	Driver's door key lock and unlock UNLOCK	Continuity
16 - Ground	Each door courtesy switch ON (door opened)	No Continuity
16 - Ground	Each door courtesy switch OFF (door closed)	Continuity
6 - Ground (RHD)	Driver's door key lock and unlock switch LOCK	No Continuity
6 - Ground (RHD)	Driver's door lock and unlock switch UNLOCK	Continuity

If circuit is not as specified, inspect power source or wire harness.

- INSPECT POWER WINDOW MASTER SWITCH CIRCUIT (See page [DI-935](#) )**

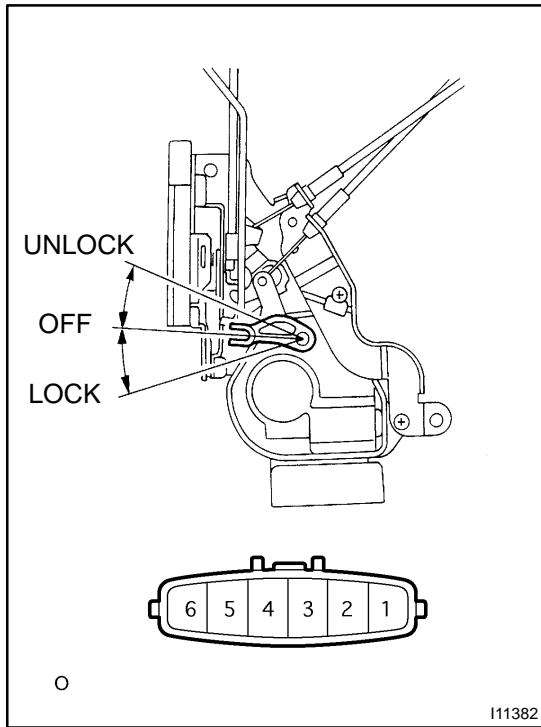

**3. INSPECT DOOR KEY LOCK AND UNLOCK SWITCH CONTINUITY**

Switch position	Tester connection	Specified condition
LOCK	2 - 4	Continuity
OFF	-	No continuity
UNLOCK	2 - 3	Continuity

If continuity is not as specified, replace the door lock assembly.

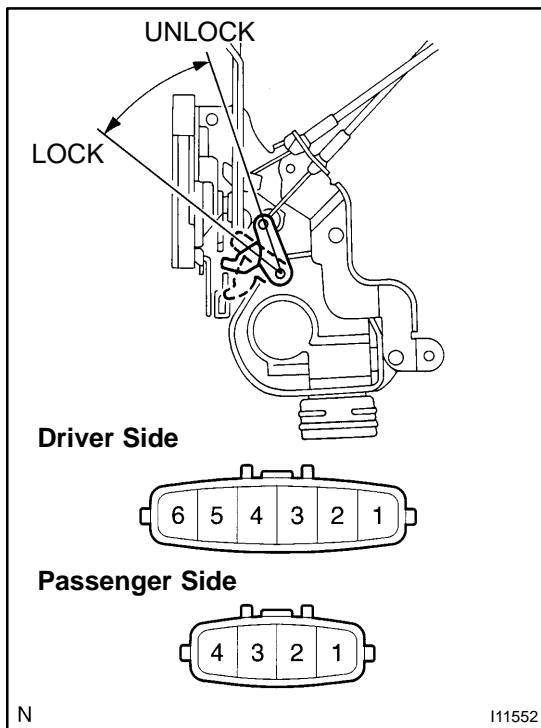

**4. INSPECT DRIVER SIDE DOOR UNLOCK DETECTION SWITCH CONTINUITY**

Switch position	Tester connection	Specified condition
OFF (Door Lock set to LOCK)	-	No continuity
ON (Door Lock set to UNLOCK)	1 - 2	Continuity

If continuity is not as specified, replace the door lock assembly.

**5. INSPECT PASSENGER DOOR UNLOCK DETECTION SWITCH CONTINUITY**

Switch position	Tester connection	Specified condition
OFF (Door Lock set to LOCK)	-	No continuity
ON (Door Lock set to UNLOCK)	3 - 4	Continuity

If continuity is not as specified, replace the door lock assembly.

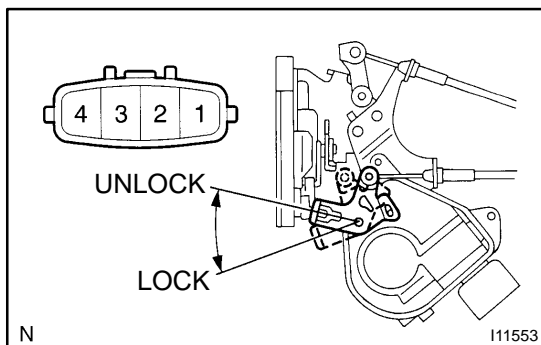

**6. INSPECT REAR DOOR UNLOCK DETECTION SWITCH CONTINUITY**

Switch position	Tester connection	Specified condition
OFF (Door Lock set to LOCK)	-	No continuity
ON (Door Lock set to UNLOCK)	1 - 2 (LH side) 3 - 4 (RH side)	Continuity

If continuity is not as specified, replace the door lock assembly.

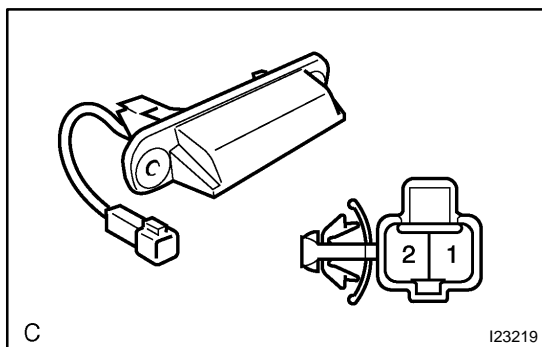

**7. INSPECT BACK DOOR OPENER SWITCH CONTINUITY**

Switch position	Tester connection	Specified condition
OFF	-	No continuity
ON	1 - 2	Continuity

If continuity is not as specified, replace the switch.

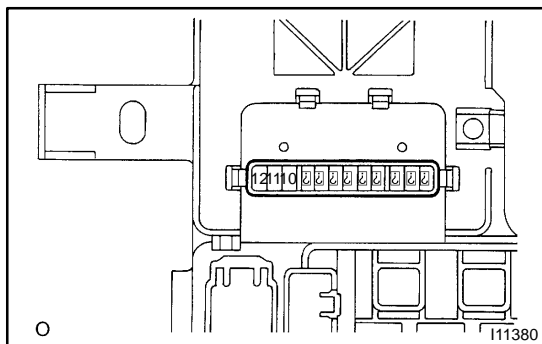

**8. INSPECT DOOR LOCK MOTOR AND J/B CIRCUIT**

- (a) Remove the body ECU from the driver's side junction block.
- (b) Connect the positive (+) lead from the battery to J/B terminal 9 and the negative (-) lead to J/B terminal 10, and check that the door lock link moves to LOCK position.
- (c) Reverse the polarity and check that the door link moves to UNLOCK position.

If operation is not as specified, inspect door lock motor.

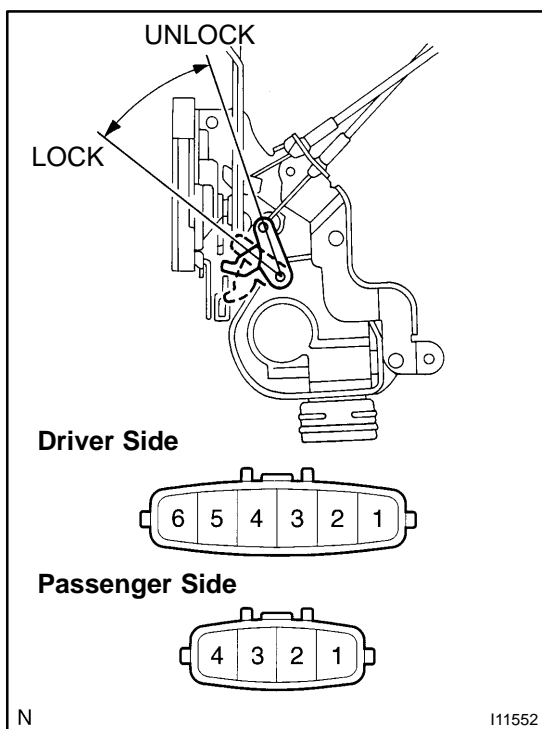

**9. INSPECT DRIVER SIDE DOOR LOCK MOTOR OPERATION**

- (a) Connect the positive (+) lead from the battery to terminal 5 and the negative (-) lead to terminal 6, and check that the door lock link moves to LOCK position.
- (b) Reverse the polarity and check that the door lock link moves to UNLOCK position.

If operation is not as specified, replace the door lock assembly.

**10. INSPECT PASSENGER SIDE DOOR LOCK MOTOR OPERATION**

- (a) Connect the positive (+) lead from the battery to terminal 1 and the negative (-) lead to terminal 2, and check that the door lock link moves to LOCK position.
- (b) Reverse the polarity and check that the door lock link moves to UNLOCK position.

If operation is not as specified, replace the door lock assembly.

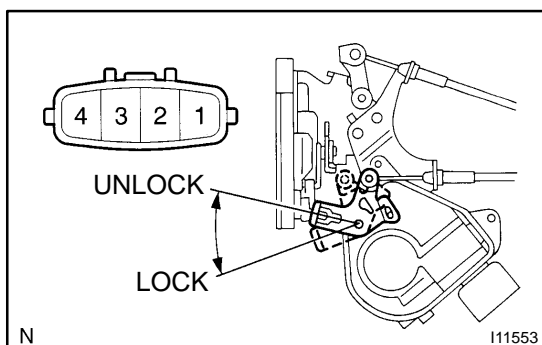

**11. INSPECT REAR DOOR LOCK MOTOR OPERATION ( ): RH side**

- (a) Connect the positive (+) lead from the battery to terminal 3 (1) and the negative (-) lead to terminal 4 (2), and check that the door lock link moves to LOCK position.
- (b) Reverse the polarity and check that the door lock link moves to UNLOCK position.

If operation is not as specified, replace the door lock assembly.

**12. INSPECT DOOR LOCK MOTOR CIRCUIT (See page DI-931 )**

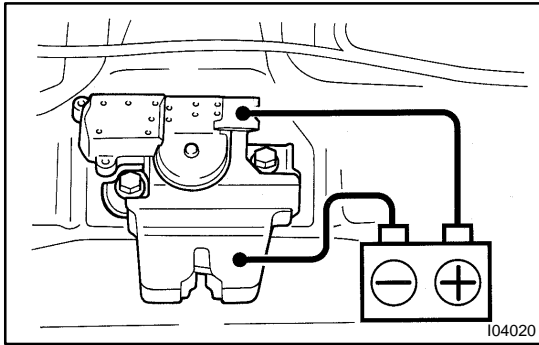

### 13. INSPECT LUGGAGE COMPARTMENT DOOR OPENER MOTOR OPERATION

Connect positive (+) lead to the terminal 1 and negative (-) lead to the opener motor body, and check that the motor operates. If operation is not as specified, replace the motor assembly.

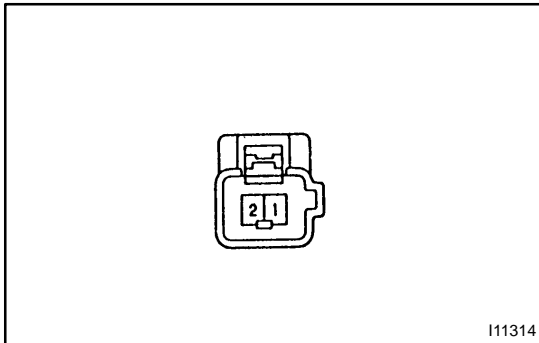

### 14. INSPECT LUGGAGE COMPARTMENT DOOR OPENER MOTOR CIRCUIT (See page [DI-927](#))

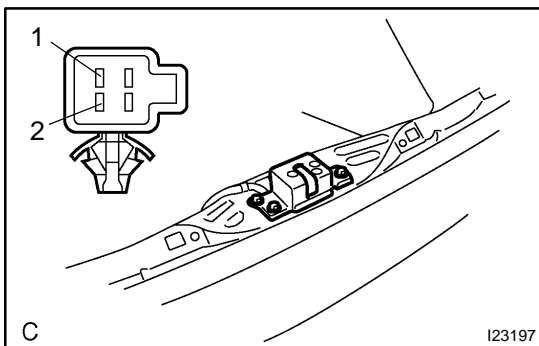

### 15. INSPECT BACK DOOR OPENER MOTOR OPERATION

Connect positive (+) lead to the terminal 1 and negative (-) lead to the terminal 2, and check that the motor operates. If operation is not as specified, replace the motor assembly.