

REAR FLOOR SIDE MEMBER REAR REINFORCEMENT (ASSY)

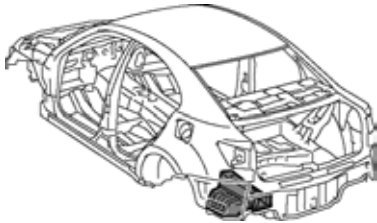

B0709140131

With the body lower back panel removed.

Symbol meaning

REMOVAL

INSTALLATION

△ △ △ : Remove Weld Points

⊗ : Cut with Disc Sander etc.

○ I M : MIG Plug Weld 🔥 : Tack Weld

REMOVAL-INSTALLATION

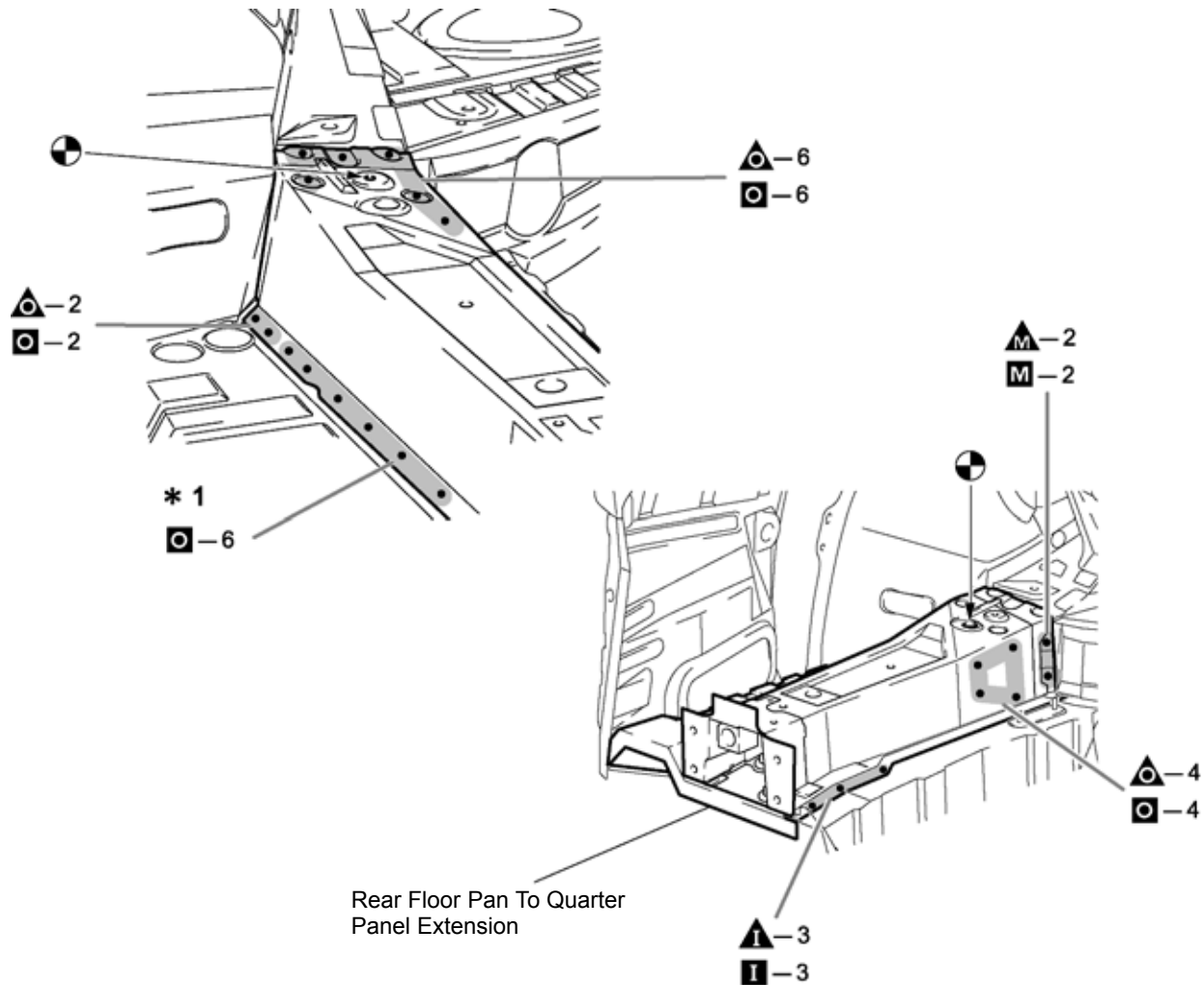

B0709140149

REMOVAL POINT

- 1 Remove the rear floor pan to quarter panel extension at the same time.

INSTALLATION POINT

- 1 Temporarily install the new parts and measure each part of the new parts in accordance with the body dimension diagram. (See the body dimension diagram)
- 2 *1 indicates installation work.
- 3 For positioning of the new parts, the installation standard holes of the Rear floor side rear member and the Rear floor side front member shall be matched.
- 4 After welding, apply body sealer and undercoating to the corresponding parts. (See the paint-coating)

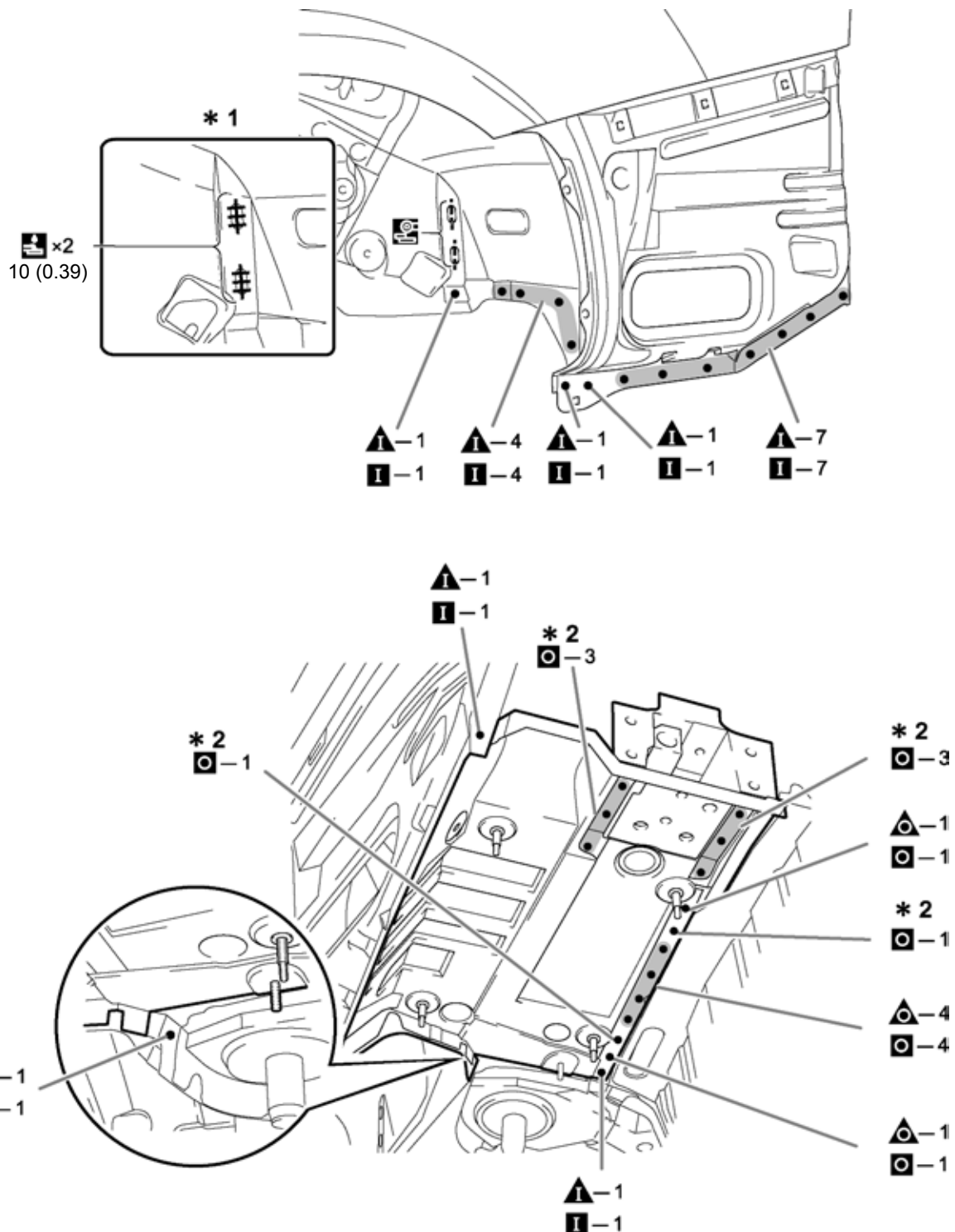

B0709140150

REMOVAL POINT

- 1 Remove the rear floor pan to quarter panel extension at the same time.

INSTALLATION POINT

- 1 For positioning of the new parts, the installation standard holes of the rear floor side rear member and the rear floor side front member shall be matched.
- 2 *1 indicates installation work.
- 3 After welding, apply body sealer and undercoating to the corresponding parts. (See the paint-coating)
- 4 After applying the top coat, apply anti-rust agent to the internal panel portion of the closed section structural weld points.